

**MAXIMUM PRODUCT LOAD RATING:****50 kg (size F)****IMPORTANT:**

- **LOAD = WEIGHT OF PLATFORM or BARS + MOUNTING SYSTEM + ACCESSORIES + CARGO**
- **PLEASE REFER TO VEHICLE MANUFACTURER SPECIFICATIONS FOR MAX ROOF LOAD CAPACITY OF VEHICLE. THE LOWEST LOAD RATING APPLIES.**
- **OFFROAD RATING: SCAN QR CODE FOR LOCKNLOAD LOAD RATING GUIDE. REDUCTIONS MAY APPLY.**

**FIRST TIME INSTALLATION**

- Please read instructions carefully before installation.
- Check the contents of kit. Contact your YAKIMA dealer if any parts appear missing or damaged.
- Clean your vehicle roof prior to fitting the LockNLoad Platform.
- Use caution when handling Platform Sides, Ends and Slats as sharp edges may be present.
- Please note other Platforms will have differing amounts of slats and hardware.
- Place these instructions in the vehicle's glove box after installation is complete.

**TOOLS REQUIRED:**

- 4 mm Ball End Allen Key or Torque Wrench
- 13 mm Socket Wrench or Spanner

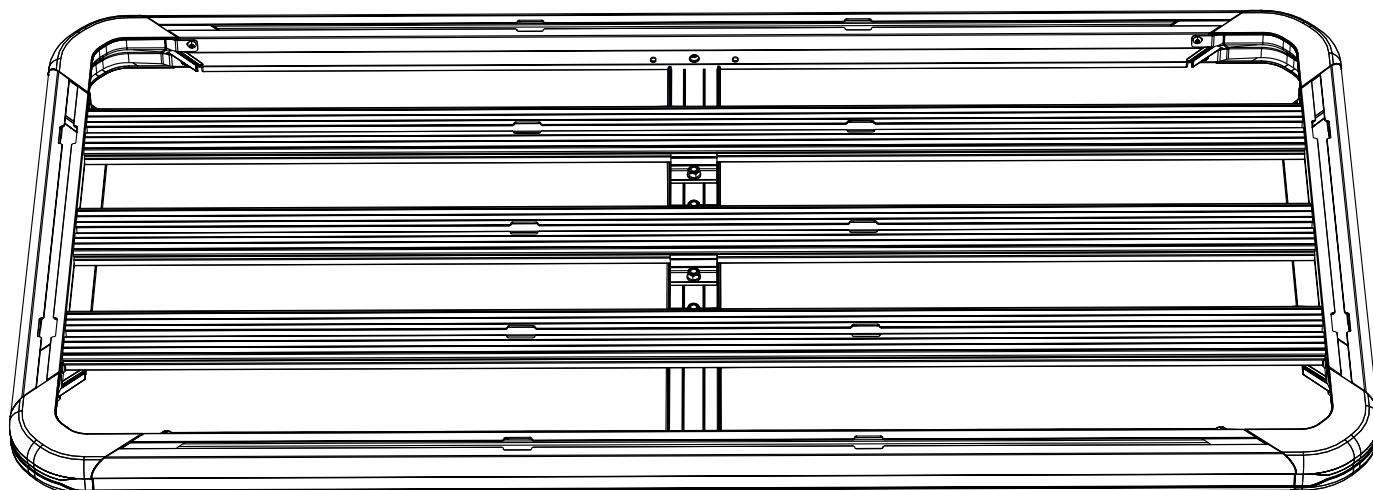

Platform F - 9820342

**KIT CONTENTS**

ITEM	COMPONENT	QTY
1.	Pre-Assembled Platform	x1
2.	Wind Deflector	x1
3.	Pivot Mount Kit	x1
4.	Spare Fasteners Pack	x1

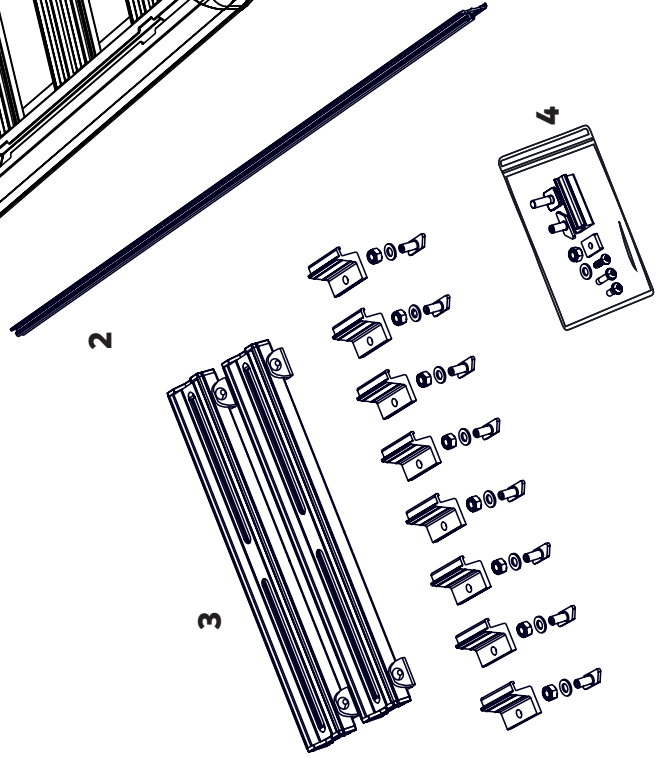
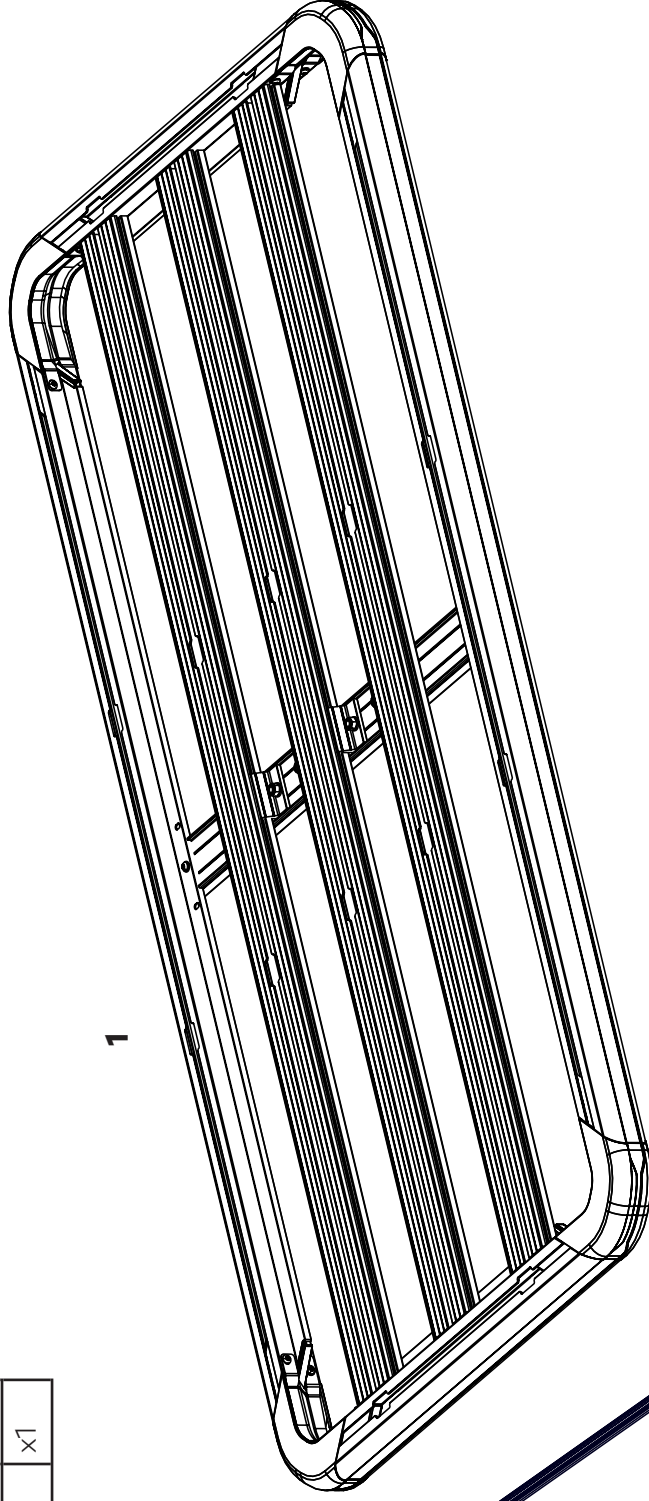

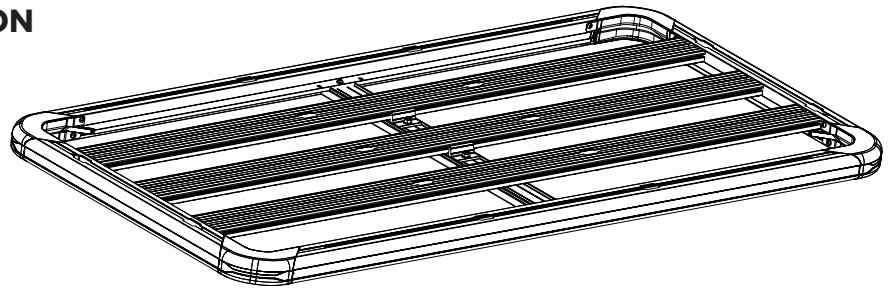
**1****REMOVE ASSEMBLED PLATFORM FROM CARTON****2****INSTALL WIND DEFLECTOR**

Install wind deflector into front of Platform. This is done by pressing one end of the deflector into the slot and working across the length of the deflector.

Installation should be confirmed by hearing an audible 'CLICK' when the deflector is fully installed.

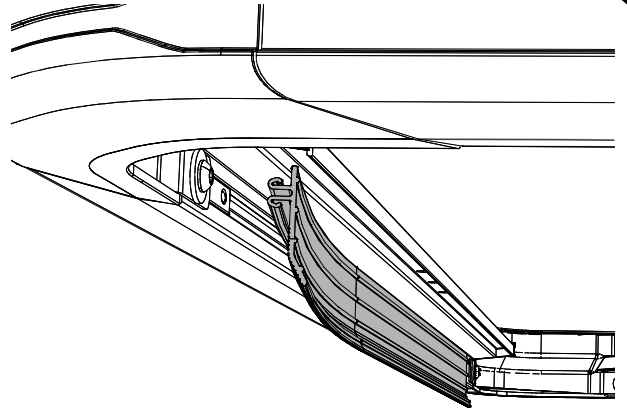

**PLEASE REFER (i) TO INFO AT TOP OF PAGE 4,  
AND; (ii) TO STEPS IN TABLE BELOW:**

NAME	IMAGE	LEG PACK PART NUMBER	PAGE	STEPS
Fixed & Track Mount Mk2		9800302 / 9800304 / 9800306	4 + 4 & 5	Special Note + 1 to 5
Fixed & Track Mount Mk1		8000142 / 8000143 / 8000144	4 + 6	Special Note + 1 to 4
Flush Rail		8002001 with 8000367	4 + 4 & 5	Special Note + 1 to 5
Gutter Mount		8000351 / 8000352 / 8000353	4 + 6	Special Note + 1 to 4
Raised Rail		8000389	4 + 5	Special Note + 5 only



## SPECIAL NOTE

Your Pivot Mounts have two sets of mounting holes at either end of the mount for leg attachments.

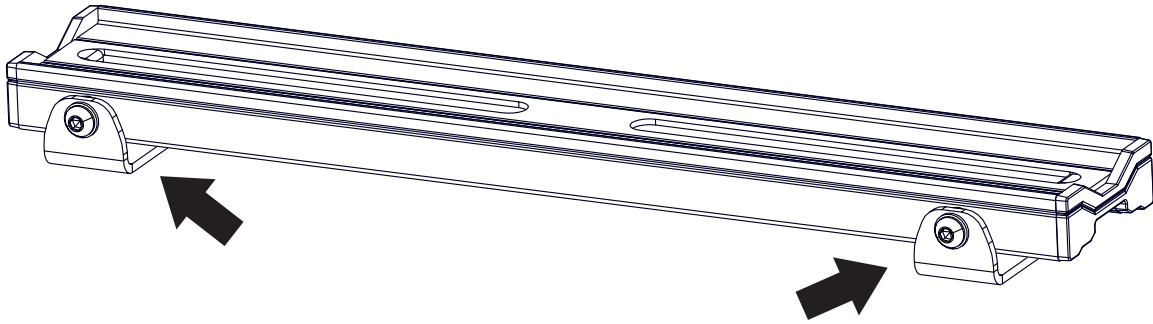

## LEG MOUNTING INSTRUCTIONS

# 1

### REMOVE LEG COVERS

Using the keys supplied in the LockNLoad Leg Kit (sold separately), remove all Leg Covers.

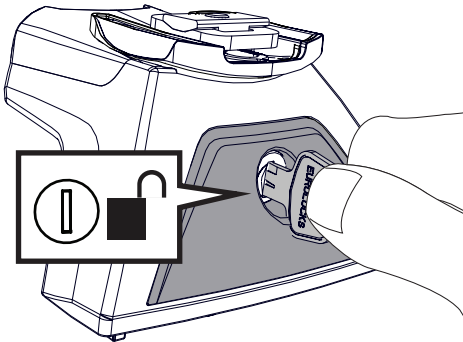

# 2

### DISASSEMBLE LEG ASSEMBLIES

Disassemble Leg components as shown and store in a safe place.

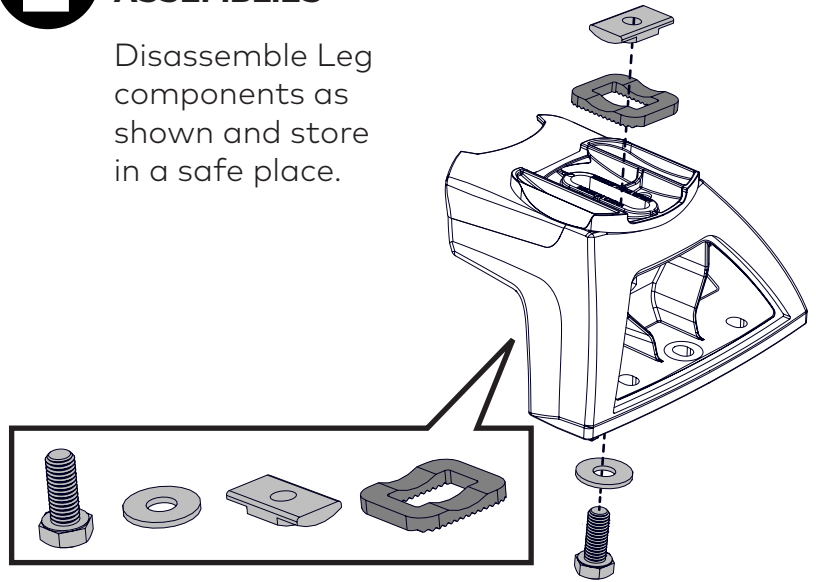

# 3

### ASSEMBLE LEGS

Assemble each Leg as shown using one Platform Mount Bracket, M8 Coach Bolt, M8 Washer and M8 Nut from the LockNLoad Leg Kit.

All Brackets should be parallel with the base of the Leg prior to tightening.

Tighten all M8 nuts to 9 Nm using a 13 mm Spanner.

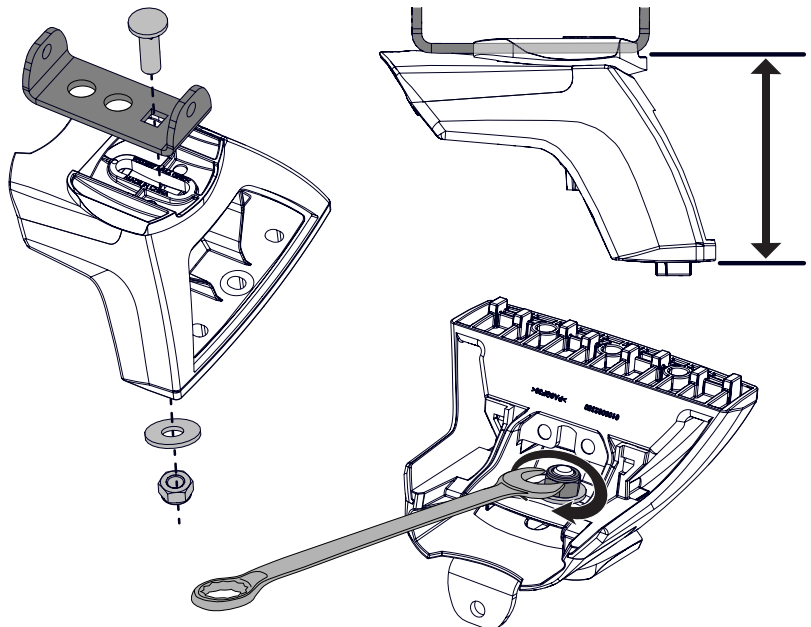

# 4

## DISASSEMBLE MOUNTING BLOCK ASSEMBLIES

Remove the M6 Capscrews from Mounting Blocks (from Pre-Assembled Platform Kit) using a 4 mm Ball End Allen Key or a suitable Torque Wrench.

Keep the M6 Capscrews with Washers aside for the next step and store the Mounting Bracket in a safe place.

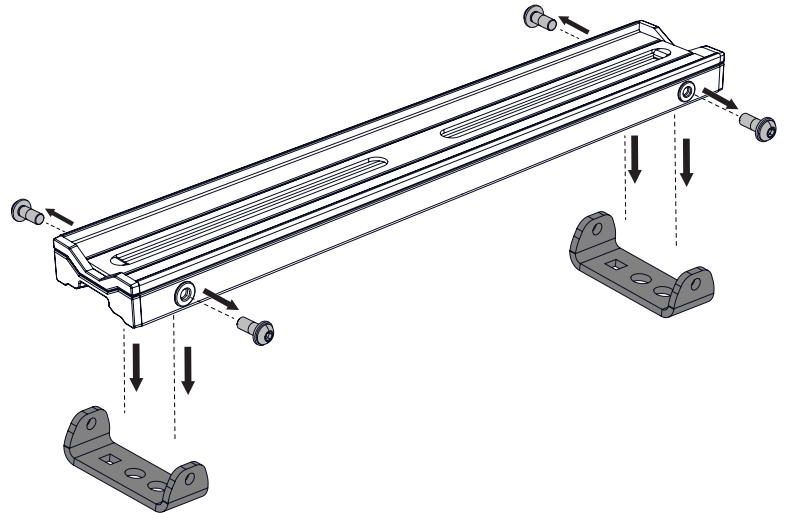

# 5

## INSTALL MOUNTING BLOCKS

Place Mounting Block on top of each Leg assembly, lining up the rivnut holes on Mounting Block with holes on tabs of Platform Mount Bracket.

Secure using the M6 Capscrews with Washers from the previous step.

Tighten all Capscrews to 4 Nm with a 4 mm Ball End Allen Key or a suitable Torque Wrench.

**NOTE** - The Mounting Block assembly will still have movement after securing which is intended.

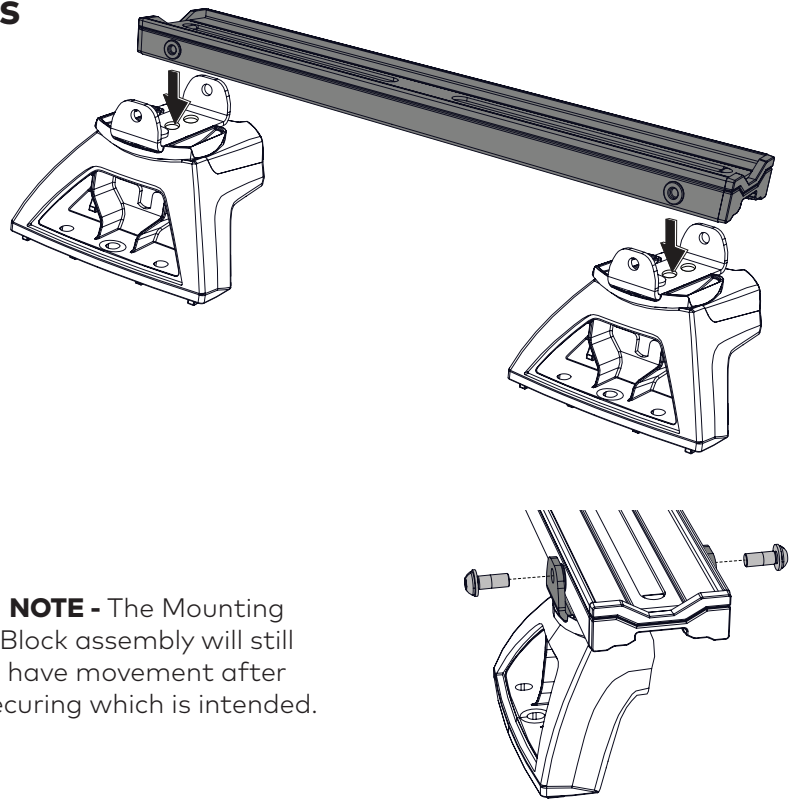

**PLEASE PROCEED TO PAGE 7 FOR  
VEHICLE MOUNTING INSTRUCTIONS**

# LEG MOUNTING INSTRUCTIONS

## 1 REMOVE LEG COVERS

Using the keys supplied in the LockNLoad Leg Kit (sold separately), remove all Leg Covers.

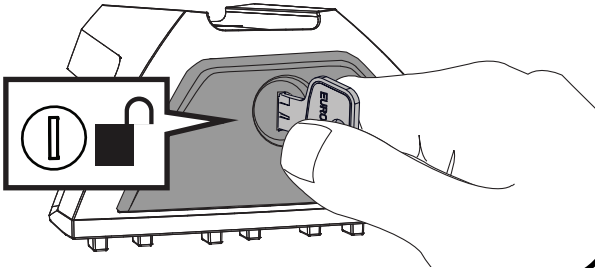

## 2 ASSEMBLE SCREWS

From the Leg Kit, assemble one M8 Washer onto each M8 Set Screw 16 mm as shown.

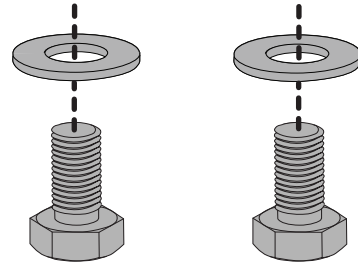

## 3 INSTALL MOUNTING BLOCK ASSEMBLIES

Place a Mounting Block assembly (from Pre-Assembled Platform Kit) on top of each Leg and insert Nut Plate (from Leg Kit) on top of Mounting Bracket as shown.

Secure using the two Screw and Washer assemblies from the previous step.

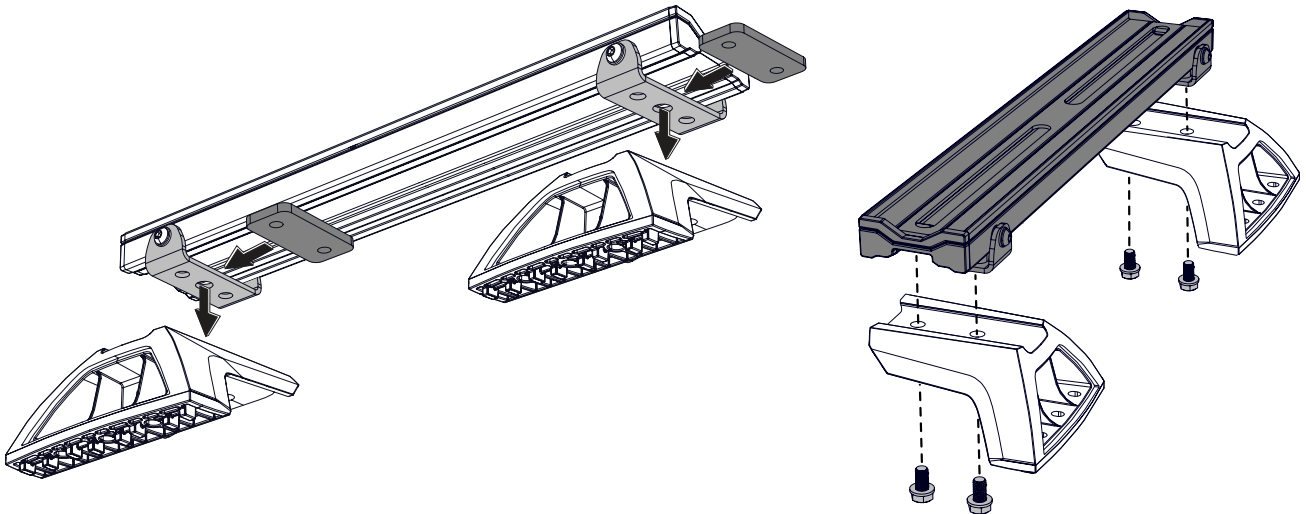

## 4 TIGHTEN MOUNTING BLOCK ASSEMBLIES TO LEGS

Tighten all M8 Set Screws to 7 Nm using a 13 mm Socket Wrench or Spanner.

**NOTE** - The Mounting Block assembly will still have movement after securing which is intended.

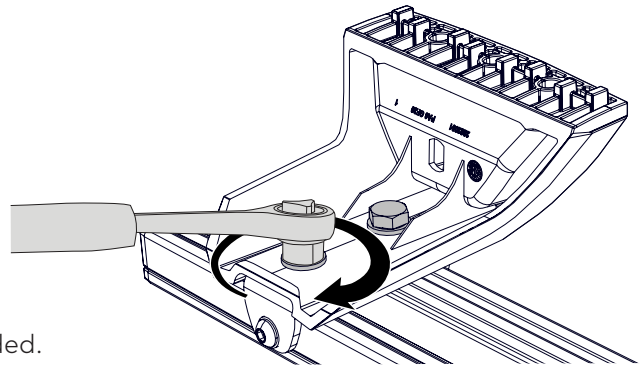

**PLEASE PROCEED TO NEXT PAGE FOR  
VEHICLE MOUNTING INSTRUCTIONS**





**4****SECURE MOUNTING BLOCKS**

Secure Mounting Blocks to Platform Slats using one Slat Clamp, one M8 Washer and one M8 Nyloc Nut onto each M8 T-Bolt as shown.

Tighten all Nuts to 7 Nm using a 13 mm Socket Wrench or Spanner.

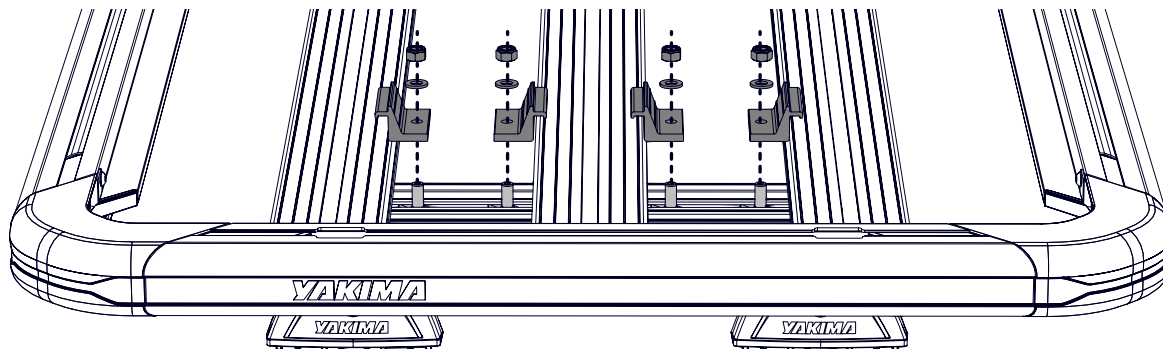

**NOTE - Do not to over tighten Slat Clamps past 7 Nm as this may reduce clamping force.**

**6****PLATFORM MOUNTING COMPLETE**

Check that Platform has been secured correctly as per the mounting instructions.

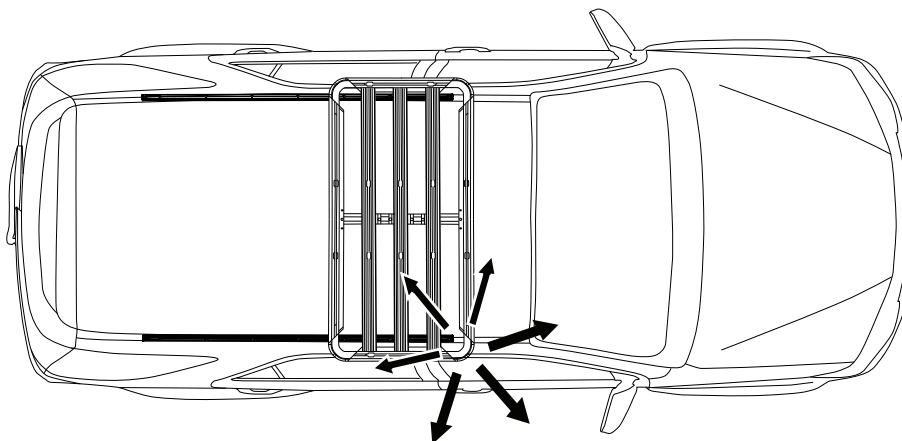
**WIND DEFLECTOR REMOVAL**

**NOTE -** The Wind Deflector can be removed to suit certain anchors/accessories to be used with the front extrusion. This is done by simply peeling the part out of the slot, starting at one end and working across the length of the deflector.

Installation is the reverse and should be confirmed by hearing an audible 'CLICK' when the deflector is fully installed.

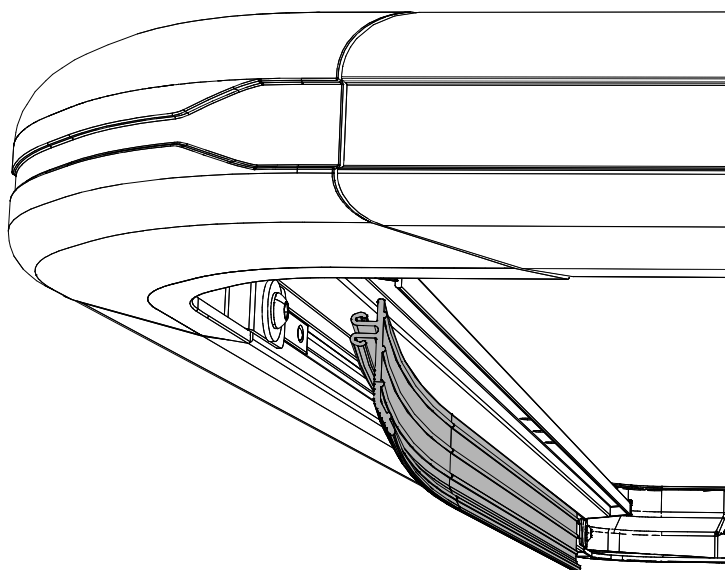



**YAKIMA**

[www.yakima.com.au](http://www.yakima.com.au)

[www.yakima.co.nz](http://www.yakima.co.nz)

[www.yakima.com](http://www.yakima.com)

[www.yakima.eu](http://www.yakima.eu)

**YAKIMA AUSTRALIA PTY LTD**

17 Hinkler Court  
Brendale, QLD 4500  
Australia  
1800 143 548

**YAKIMA PRODUCTS, INC.**

4101 Kruse Way  
Lake Oswego, OR  
97035-2541  
USA  
888 925 4621

**ALL CONTENT SUBJECT TO YAKIMA AUSTRALIA PTY LTD COPYRIGHT © 2022**